



PILAEDU Academy

PILAedu will make you change your future

Adult
(Mar,05 2025)

Contents



Introduction

1. Structure
 - Dormitory

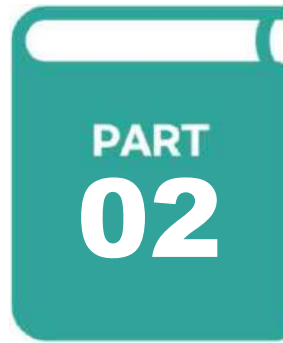

Education

1. Program
2. Level system
3. Report card
4. Daily schedule
5. Monthly schedule



Procedure

1. Enrollment Process
2. price
 - Tuition fee
 - Local fee
 - Option fee
3. Refund policy
 - Check-in, check-out
 - deposit refund



PART
01

1. Structure
- Dormitory

Structure of the School (condo single A or twin A)

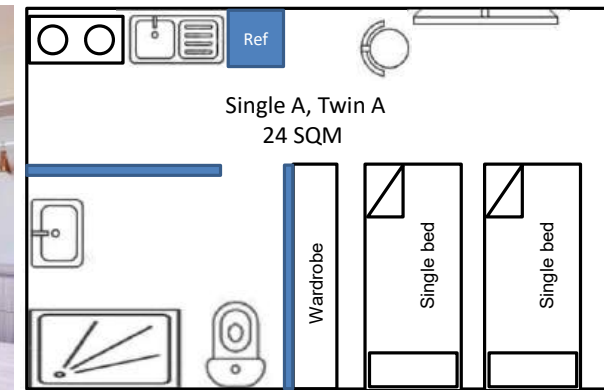

Condo single or twin room
single A or twin B is about 24sqm in size, all the appliances for basic living
are provided. Cooking is possible. Companion registration only for twin A.

Inclusion

1. Furniture : bed(extra bed), dining table, chair, sofa, cabinet(closet), air-conditioner, TV, internet, hanger and vault
2. Kitchen : rice cooker, stove, sink, refrigerator, water dispenser, microwave and cooking utensils
3. Bathroom: Water heater, Shower, Toilet, basin, hair dryer and towels(twice a week change)
4. Welcome kit : only first day provide (toilet paper, tissue and tooth brush and paste, snack and drink)

* Cold and hot water dispenser can be applied to the lobby when it runs out. (About 150 ~ 200P)

Structure of the School (Single B or dormitory twin B)

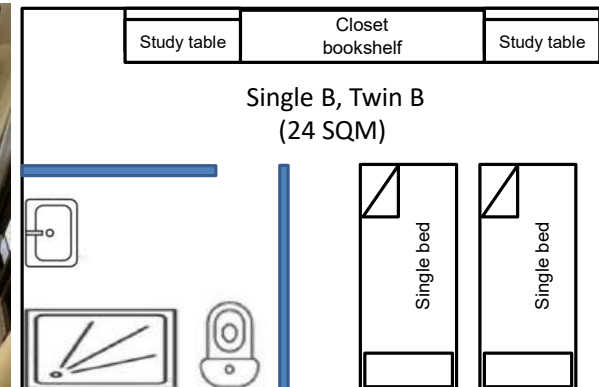

It's a single or twin room that uses a regular dorm. Unlike Single A, no kitchen. It is a room with more environment for learning. If it is used as a twin room, it is the only room that can be accommodated for couples, Companion registration only.

Inclusion

1. Furniture : Bed, study table, chair, book-shelve, cabinet(closet), vault, air-conditioner, internet and Ref(by request)
2. Bathroom: Water heater, Shower, Toilet, basin and hair dryer
3. Welcome kit : only first day provide (toilet paper, snack and drink)

Structure of the School (dormitory twin C)



Twin room

It is a room that provides private restrooms among regular dormitories.
It is a room equipped with all the necessary environments for learning.

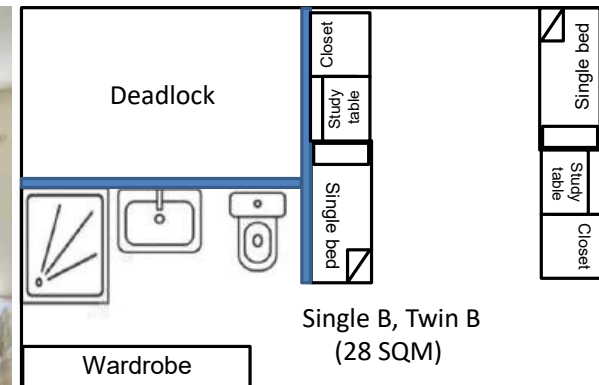

Inclusion

1. Furniture : Bed, study table, chair, book-shelve, cabinet(closet), vault, air-conditioner, internet and Ref(by request)
2. Bathroom: Water heater, Shower, Toilet, basin and hair dryer
3. Welcome kit : only first day provide (toilet paper, snack and drink)

Structure of the School (dormitory quad B)



Premium quad room (above 4weeks registration)
Quad room A, It is an optimized room for long-term students. The space given to individual students is the size of a single room B, and although there is a roommate, a large private space is provided

Inclusion

1. Furniture : Bed, study table, chair, book-shelve, cabinet(closet), vault, air-conditioner and internet modem, electric fan, ref by request
2. Common T/B : Water heater, Shower, Toilet, basin and hair dryer
3. Welcome kit : only first day provide (toilet paper, snack and drink)

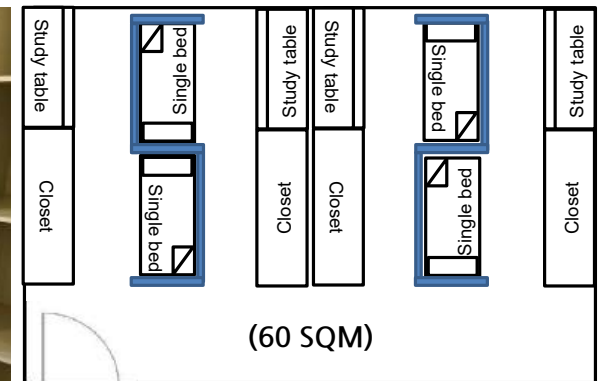

Structure of the School (dormitory quad C)



Standard quad room

It seems like a separate two-person room, so there is no inconvenience in training. Private spaces are also well-separated and are common dormitories where you can stay at an affordable price.

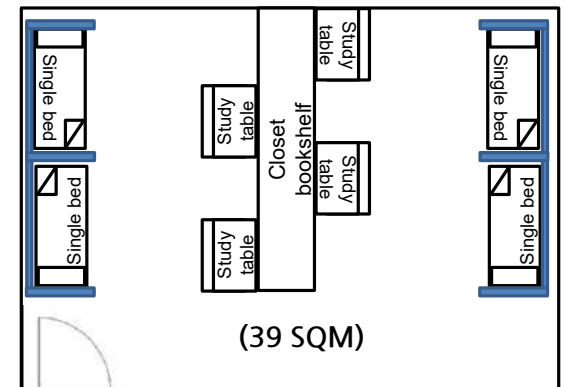

Inclusion

1. Furniture : Bed, study table, chair, book-shelve, cabinet(closet), vault, air-conditioner and internet modem, electric fan, ref by request
2. Common T/B : Water heater, Shower, Toilet, basin and hair dryer
3. Welcome kit : only first day provide (toilet paper, snack and drink)

Structure of the School (Common T/B for quad room)



It is a public toilet/bath to students who use a four-person room. The most common complaint is that students from different countries are different hygiene concept so the academy maintains cleanliness. (We have also swimming pool common T/B on Mezzanine Floor)

Structure

1. Toilet : The number of toilets and the number of urinators varies according to gender..
2. Shower : Water heater, shower, hanger for towel and soap holder.
3. Basin : Mirror, brush cup, soap holder and Hair dryer.



Structure of the School (Condo)

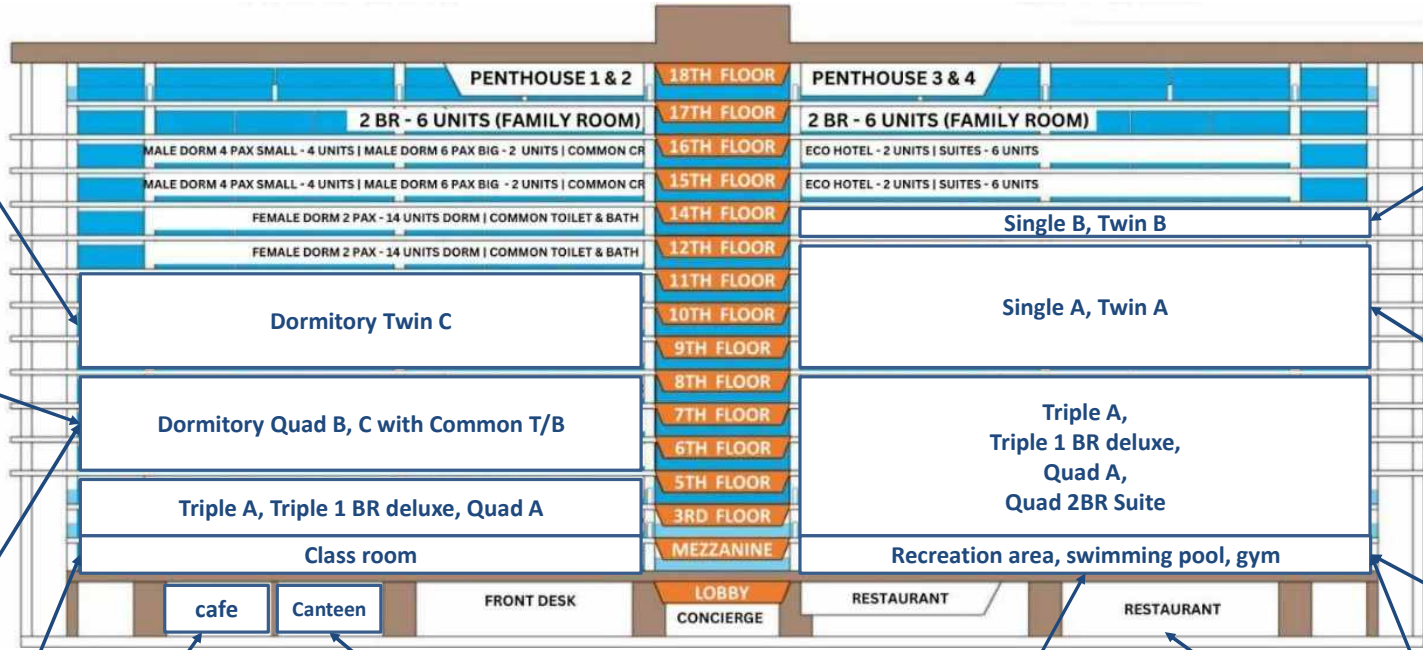



PART
02

1. Program
2. Level system
3. Report card
4. Daily schedule
5. Monthly schedule

School adult Programs (ESL & Business)

Trial ESL

Man to man : 3 times
Big group class : 1 time

Total 4 times

LITE ESL

Man to man : 4 times
Small group : 1 time
Big group class : 1 time

Total 6 times

REGULAR ESL

Man to man : 5 times
Small group : 2 times
Big group class : 1 time

Total 8 times

INTENSIVE ESL

Man to man : 6 times
Small group : 2 times
Big group class : 1 time

Total 9 times

One-on-one class(You can't choose the same subject for more than 2 hours) : speaking/listening, writing, reading, grammar, Option 1:1 (survival, Business, TOEIC)

Option One-on-one class : Business: Learning English for business (using business books)

: Survival: A program where you can go out with a teacher to speak English naturally (from week 3)

: TOEIC (selectable from regular or Intensive ESL): TOEIC classes can be selected in the general ESL course (using TOEIC books)

Small Group (1 : 4~6) : Based on the Cambridge grammar curriculum, it is a hands-on class. (Proceed by Hand-out or activity)

(1 : 4~6) : Media Topic classes : debate with Herald, TED, CNN news / Pop song, Soap Opera, Movie understanding

- Classes will be held with contents based on a total of four weeks for each level, with contents of one to two weeks and contents of three to four weeks.

- The level test in Weeks 2 and 4 may change the group class the following Monday.

* The test results are not disclosed because they are personal information, and you can check the personal results by requesting from the education office.

* We do not conduct a test review. (Tests by level are classified into A and B types.)

Large group(Voca) : There may be differences in levels because the classes are only divided into three criteria (e.g., Beginner Level 1, 2, 3 Same classes are allowed)

School adult Programs (IELTS program description)

Category	Pre-IELTS
Level	Beginner, Pre – Intermediate
Duration	Below 4 Weeks
Band score	IELTS below 3.0
Mock test	Every Thursday and Feedback every Friday
Teachers	IELTS team only for IELTS subject

Category	Regular-IELTS
Level	Intermediate, upper-intermediate, advance
Duration	Minimum 8 Weeks above
Band score	IELTS below 4.0 above
Mock Test	Every Thursday and Feedback every Friday
Teachers	IELTS team only for IELTS subject
Official Test	Free to provide

- The IELTS program allows you to select Pre-IELTS and Regular IELTS.
- Pre-IELTS: If you are below Band level 3, you can apply from the PILA Beginner level.
 - Four hours of one-on-one class will be held, and four hours of group class and one hour of after-school class will be provided.
 - One-on-one class textbooks use COLINS English for exam get ready for IELTS by area, and grammar lessons are provided with regular ESL grammar.
 - In the case of group classes, vocabulary classes, IELTS grammar, and listening classes are provided in preparation for basic IELTS tests.
- Regular-IELTS: You can apply for Band level 4 or higher, and you can apply from the PILA intermediate level.
 - Four hours of one-on-one class will be held, and four hours of group class and one hour of after-school class will be provided.
 - One-on-one class textbooks will be provided as textbooks for each area of IELTS preparation and practice academic module.
 - Group teaching materials are based on Cambridge IELTS Academy 11-18 Edition.
- IELTS OFFICIAL TEST SUPPORT CONDITIONS
 - For more than 8 weeks, the Regular-IELTS program supports the cost of an Official examination for students who have applied.
 - **More than 80% of the word test will be conducted on Mondays and Thursdays**
 - **Mock-up test increases band level more than once every four weeks and increases IELTS score by one point.**

School adult Programs (IELTS program)

Category	Pre-IELTS
Level	Beginner, Pre – Intermediate
Duration	Below 4 Weeks
Band score	IELTS below 3.0
Benefits	Mock test (every Thursday and Feedback every Friday)
Teachers	IELTS team only for IELTS subject

Learner	Level	CERF. Level	Band Score
Basic user	Pre-beginner, Beginner, Upper-beginner	A1	2.0 – 2.5
	Pre-intermediate	A2	3.0 – 3.5
Independent user	Intermediate	B1	4.0 – 4.5
	Upper-intermediate	B2	5.5 – 6.5
Proficient user	Advance	C1	7.0 – 8.0
	Proficient	C2	8.5 – 9.0

Course	1 ST Class	2 ND Class	3 RD Class	4 TH Class	5 TH Class	6 TH Class	7 TH Class	8 TH Class	9 TH class
Pre IELTS	1 : 1	1 : 1	1 : 1	1 : 1	Group (1:8)	Group(1:8)	Group(1:8)	Group(1:8)	Group(1:8)
Subject	Writing(T1)	Speaking	Reading	Grammar in use	Vocabulary	Listening	Writing(T2)	Grammar IELTS	Vocabulary test
Textbook	Collins English form exam get ready for IELTS Pre-inter A2 (Listening, Writing, Reading, Speaking), Collins get ready for IELTS Pre-intermediate to intermediate 3.5-4.5								

Subject	Detail Contents
Writing(T1&T2)	<ul style="list-style-type: none"> • Coherence and cohesion of ideas with appropriate use of reference and logical connectors. • Appropriate paragraphing with clear main ideas and adequate support. • Accurate use of a wide range of lexical resources, collocations, verb tenses and phrasal verbs. • Fluent use of a wide variety of grammatical structures with a predominance of compound and complex sentences. • Equipped the candidate with the necessary knowledge on handling IELTS Writing task 1&2.
Speaking	<ul style="list-style-type: none"> • Appropriate use of a variety of words and use of well-connected sentence structures with consistent accuracy. • Ability to discuss a variety of topics fluently and develop the topic well. • Familiarize with the parts of the speaking test as well as the criteria of scoring.
Reading	<ul style="list-style-type: none"> • Acquiring the necessary reading skill to approach each question type strategically. • Getting information from a written text. • Applying skimming, scanning, reading for required information, identifying the purpose and main idea of text, and making inferences.
Grammar in use	<ul style="list-style-type: none"> • Maintains a focused and intensive review and reinforcement of the rules in grammar as learned in the group class.
Grammar IELTS	<ul style="list-style-type: none"> • Provide the necessary grammatical rules and knowledge to the candidate in both writing and speaking.
Listening	<ul style="list-style-type: none"> • Improving listening skills by understanding the structure and information of IELTS listening contents. • Getting information from a spoken text. • Application strategies include listening stressed syllables, guessing meaning from context, listening for required information, and hearing differences between similar sounds.
Vocabulary	<ul style="list-style-type: none"> • Entails to build and reinforce the lexical repertoire of the candidate in order to discuss or write a variety of topics. (25 words)

School adult Programs (IELTS program)

Category	Regular-IELTS
Level	Intermediate, upper-intermediate, advance
Duration	Minimum 8 Weeks above
Band score	IELTS below 4.0 above
Benefits	Mock test (every Thursday and Feedback every Friday)
Teachers	IELTS team only for IELTS subject
Official Test	Free (once a 2 months)

Learner	Level	CERF. Level	Band Score
Basic user	Pre-beginner, Beginner, Upper-beginner	A1	2.0 – 2.5
	Pre-intermediate	A2	3.0 – 3.5
Independent user	Intermediate	B1	4.0 – 4.5
	Upper-intermediate	B2	5.5 – 6.5
Proficient user	Advance	C1	7.0 – 8.0
	Proficient	C2	8.5 – 9.0

Course	1 ST Class	2 ND Class	3 ^{RE} Class	4 TH Class	5 TH Class	6 TH Class	7 TH Class	8 TH Class	9 th class
Pre IELTS	1 : 1	1 : 1	1 : 1	1 : 1	Group (1:8)	Group(1:8)	Group(1:8)	Group(1:8)	Group(1:8)
Subject	Writing(T1)	Speaking	Reading	Listening	Speaking	Reading	Writing(T1)	Listening	Vocabulary test
Textbook	Cambridge IELTS 15 to 19 academic, Barron's IELTS practice exam, IELTS preparation and practice module (Reading and Writing, Listening and Speaking)								

Subject	Detail Contents
Writing(T1&T2)	<ul style="list-style-type: none"> Coherence and cohesion of ideas with appropriate use of reference and logical connectors. Appropriate paragraphing with clear main ideas and adequate support. Accurate use of a wide range of lexical resources, collocations, verb tenses and phrasal verbs. Fluent use of a wide variety of grammatical structures with a predominance of compound and complex sentences. Equipped the candidate with the necessary knowledge on handling IELTS Writing task 1&2.
Speaking	<ul style="list-style-type: none"> Appropriate use of a variety of words and use of well-connected sentence structures with consistent accuracy. Ability to discuss a variety of topics fluently and develop the topic well. Familiarize with the parts of the speaking test as well as the criteria of scoring.
Reading	<ul style="list-style-type: none"> Acquiring the necessary reading skill to approach each question type strategically. Getting information from a written text. Applying skimming, scanning, reading for required information, identifying the purpose and main idea of text, and making inferences.
Grammar in use	<ul style="list-style-type: none"> Maintains a focused and intensive review and reinforcement of the rules in grammar as learned in the group class.
Grammar IELTS	<ul style="list-style-type: none"> Provide the necessary grammatical rules and knowledge to the candidate in both writing and speaking.
Listening	<ul style="list-style-type: none"> Improving listening skills by understanding the structure and information of IELTS listening contents. Getting information from a spoken text. Application strategies include listening stressed syllables, guessing meaning from context, listening for required information, and hearing differences between similar sounds.
Vocabulary	<ul style="list-style-type: none"> Entails to build and reinforce the lexical repertoire of the candidate in order to discuss or write a variety of topics. (40 words)

School adult Programs (TOEFL program)

Category	Pre-TOEFL
Level	Beginner, Pre – Intermediate
Duration	Minimum 4 Weeks
Band score	TOEFL below 50
Mock test	Twice a month also mini test
Teachers	TOEFL team only for TOEFL subject

Category	Regular-TOEFL
Level	Intermediate, upper-intermediate, advance
Duration	Minimum 8 Weeks above
Band score	TOEFL below 50 above
Mock Test	Twice a month / mini test every Friday
Teachers	TOEFL team only for TOEFL subject
Official Test	Free (once a 2 months)

- The TOEFL program allows you to select Pre-TOEFL and Regular TOEFL.
- Pre-TOEFL: If you are below Band level 3, you can apply from the PILA Beginner level.
 - Four hours of one-on-one class will be held, and four hours of group class and one hour of after-school class will be provided.
 - One-on-one class textbooks use Building skills for the TOEFL IBT beginning by area, and grammar lessons are provided with regular ESL grammar.
 - In the case of group classes, vocabulary classes, ESL grammar, and listening classes are provided in preparation for basic TOEFL tests.
- Regular-TOEFL: You can apply for Band level 4 or higher, and you can apply from the PILA intermediate level.
 - Four hours of one-on-one class will be held, and four hours of group class and one hour of after-school class will be provided.
 - One-on-one class textbooks will be provided as textbooks for each area of TOEFL preparation and practice academic module.
 - Group teaching materials are based on Collins skill for the TOEFL IBT test.
- TOEFL OFFICIAL TEST SUPPORT CONDITIONS
 - For more than 8 weeks, the Regular-TOEFL program supports the cost of an Official examination for students who have applied.
 - More than 80% of the word test will be conducted on Mondays and Thursdays
 - Mock-up test increases band level more than once every four weeks and increases TOEFL score by ten point.

School adult Programs (Pre-TOEFL program)

Category	Pre-TOEFL
Level	Beginner, Pre – Intermediate
Duration	Minimum 4 Weeks
Band score	TOEFL below 50
Mock test	Twice a month / mini test every Friday
Teachers	TOEFL team only for TOEFL subject

Learner	Level	CERF. Level	TOEFL Score
Basic user	Pre-beginner, Beginner, Upper-beginner	A1	35-45
	Pre-intermediate	A2	46-59
Independent user	Intermediate	B1	60-78
	Upper-intermediate	B2	79-93
Proficient user	Advance	C1	94-101
	Proficient	C2	102-109

Course	1 ST Class	2 ND Class	3 RD Class	4 TH Class	5 TH Class	6 TH Class	7 TH Class	8 TH Class	9 TH class
Pre IELTS	1 : 1	1 : 1	1 : 1	1 : 1	Group (1:8)	Group(1:8)	Group(1:8)	Group(1:8)	Group(1:8)
Subject	Writing	Speaking	Reading	Grammar in use	Vocabulary	Listening		Grammar TOEFL	Vocabulary test
Textbook	Building skills for the IBT beginning second edition (Listening, Reading, Writing, Speaking), Barron's essential words for the TOEFL 7 th edition								

Subject	Detail Contents
Writing(T1&T2)	<ul style="list-style-type: none"> • Coherence and cohesion of ideas, with effective use of references and logical connectors. • Appropriate paragraphing with clear main ideas and adequate support. • Accurate use of a wide range of vocabulary, collocations, verb tenses, and phrasal verbs. • Fluent use of diverse grammatical structures, primarily compound and complex sentences. • Knowledge of how to approach TOEFL Writing tasks 1 and 2 effectively.
Speaking	<ul style="list-style-type: none"> • Appropriate use of a diverse vocabulary. • Well-connected sentence structures with consistent accuracy. • Ability to discuss a variety of topics fluently and develop ideas effectively. • Familiarity with the speaking test format and scoring criteria.
Reading	<ul style="list-style-type: none"> • Develop essential reading skills to tackle various question types strategically. • Extract information from written texts. • Utilize techniques such as skimming, scanning, reading for specific information, and identifying the purpose and main idea of texts, and making inferences.
Grammar in use	<ul style="list-style-type: none"> • Offer focused and intensive review and reinforcement of grammar rules learned in group classes.
Grammar IELTS	<ul style="list-style-type: none"> • Provide essential grammatical rules and knowledge applicable to both writing and speaking.
Listening	<ul style="list-style-type: none"> • Enhance listening skills by understanding the structure and content of TOEFL listening materials. • Gather information from spoken texts. • Apply strategies such as recognizing stressed syllables, inferring meaning from context, listening for key information, and distinguishing between similar sounds.
Vocabulary	<ul style="list-style-type: none"> • Focus on building and reinforcing the candidate's lexical repertoire to facilitate discussion and writing on various topics.

School adult Programs (Regular-TOEFL program)

Category	Regular-TOEFL
Level	Intermediate, upper-intermediate, advance
Duration	Minimum 4 Weeks
Band score	TOEFL above 50
Mock test	Twice a month / mini test every Friday
Teachers	TOEFL team only for TOEFL subject
Official Test	Free (once a 2 months)

Learner	Level	CERF. Level	TOEFL Score
Basic user	Pre-beginner, Beginner, Upper-beginner	A1	35-45
	Pre-intermediate	A2	46-59
Independent user	Intermediate	B1	60-78
	Upper-intermediate	B2	79-93
Proficient user	Advance	C1	94-101
	Proficient	C2	102-109

Course	1 ST Class	2 ND Class	3 RD Class	4 TH Class	5 TH Class	6 TH Class	7 TH Class	8 TH Class	9 TH class
Pre IELTS	1 : 1	1 : 1	1 : 1	1 : 1	Group (1:8)	Group(1:8)	Group(1:8)	Group(1:8)	Group(1:8)
Subject	Writing	Speaking	Reading	Grammar TOEFL	Reading	Listening	Writing	Speaking	Review
Textbook	Building skills for the IBT beginning second edition (Listening, Reading, Writing, Speaking), Barron's essential words for the TOEFL 7 th edition								

Subject	Detail Contents
Writing(T1&T2)	<ul style="list-style-type: none"> • Coherence and cohesion of ideas, with effective use of references and logical connectors. • Appropriate paragraphing with clear main ideas and adequate support. • Accurate use of a wide range of vocabulary, collocations, verb tenses, and phrasal verbs. • Fluent use of diverse grammatical structures, primarily compound and complex sentences. • Knowledge of how to approach TOEFL Writing tasks 1 and 2 effectively.
Speaking	<ul style="list-style-type: none"> • Appropriate use of a diverse vocabulary. • Well-connected sentence structures with consistent accuracy. • Ability to discuss a variety of topics fluently and develop ideas effectively. • Familiarity with the speaking test format and scoring criteria.
Reading	<ul style="list-style-type: none"> • Develop essential reading skills to tackle various question types strategically. • Extract information from written texts. • Utilize techniques such as skimming, scanning, reading for specific information, and identifying the purpose and main idea of texts, and making inferences.
Grammar in use	<ul style="list-style-type: none"> • Offer focused and intensive review and reinforcement of grammar rules learned in group classes.
Grammar IELTS	<ul style="list-style-type: none"> • Provide essential grammatical rules and knowledge applicable to both writing and speaking.
Listening	<ul style="list-style-type: none"> • Enhance listening skills by understanding the structure and content of TOEFL listening materials. • Gather information from spoken texts. • Apply strategies such as recognizing stressed syllables, inferring meaning from context, listening for key information, and distinguishing between similar sounds.
Vocabulary	<ul style="list-style-type: none"> • Focus on building and reinforcing the candidate's lexical repertoire to facilitate discussion and writing on various topics.

**Total 1 level**

The basis of studying English
Level to lay the foundation of English learning,
from alphabets and parts of speech to
components of sentences

Starter

**Total 3 levels**

Level of basic English speakers who can
understand and use everyday familiar
expressions and very basic phrases

Pre beginner
Beginner
Upper beginner

**Total 3 levels**

Level to understand familiar topics, use
sentences, give opinions, and explain them

Pre intermediate
Intermediate
Upper intermediate

Level to apply for TEST program

**Total 1 levels**

Level to use clear and detailed expressions
and to have conversations at a fluent and
natural level

Advance

- The regular level test will be held once a month. (Group classes may change next Monday depending on the test results.)
- Students arriving in weeks 1 to 2 will be tested on the last Friday, and students arriving in weeks 3 to 4 will be tested on Friday the second week of next month.
- Students who take the test on the second Friday and the last Friday of each month have no class after the regular test.
- Students who can not take the regular level test according to the training schedule can apply for the graduation test. (Application for evaluation report)

Daily schedule

Time	Class	Subject	Time	Subject
Mondays to Fridays(EXCEPT the test week Friday)			Schedule of Test week Friday	
7 : 00 ~ 7 : 50	Breakfast		7 : 00 ~ 7 : 50	Breakfast
8 : 00 ~ 8 : 50	1 st class	Regular subject	8 : 00 ~ 10 : 50	Level Test
9 : 00 ~ 9 : 50	2 nd class			
10 : 00 ~ 10 : 50	3 rd class			
11 : 00 ~ 11 : 50	4 th class		11 : 00 ~ 11 : 50	Graduation ceremony
12 : 00 ~ 12 : 50	Lunch break		12 : 00 ~ 12 : 50	Lunch break
13 : 00 ~ 13 : 50	5 th class	Regular subject	13 : 00 ~ 17 : 50	Free Time Or English Festival or Culmination (Notice through the monthly schedule)
14 : 00 ~ 14 : 50	6 th class			
15 : 00 ~ 15 : 50	7 th class			
16 : 00 ~ 16 : 50	8 th class			
17 : 00 ~ 17 : 50	9 th class			
18 : 00 ~ 18 : 50	Dinner		18 : 00 ~ 18 : 50	Dinner

The student only take the classes by their choice. (**Total 9 classes will not be given to all students**)

The student can request to add-up or change classes but it will be effective next Monday (**It depends on possibility**)

Monthly schedule

Sunday	Monday	Tuesday	Wednesday	Thursday	Friday	Saturday
7/2	7/3	7/4	7/5	7/6	7/7	7/8
No class	Regular class Level test (O/T)	Regular class	Regular class	Regular class	Regular class	City tour
7/9	7/10	7/11	7/12	7/13	7/14	7/15
No class	Regular class Level test (O/T)	Regular class	Regular class	Regular class	General level test	None
7/16	7/17	7/18	7/19	7/20	7/21	7/22
No class	Regular class Level test (O/T)	Regular class	Regular class	Regular class	Regular class	Island hopping
7/23	7/24	7/25	7/26	7/27	7/28	7/29
No class	Regular class Level test (O/T)	Regular class	Regular class	Regular class	General level test	None

※ Schedule would be changed by local situation.

※ This is only sample schedule. (Every first day of the month, Activity schedule would be posted on school board)



PART
04

1. Enrollment

2. Price

- School fee
- Local fee
- Optional fee

3. Refund policy

- Check-in, check-out
- Deposit refund

Enrollment process



Start

choose your program, dormitory type and date of your study period.



Enrollment

Pay for your enrollment fee to hold your slot within 3days.



Preparation

Check your Passport expiration. It is supposed to be more than 6month left until the end of your study.

Flight ticket must be round trip ticket.



4weeks left

You must pay school fee fully if not your enrollment will be canceled without notice.

Last chance to change your mind for fully refund except enrollment fee.



2weeks left

Check school departure orientation before coming to school and connect to school contacts.

Phone :
+63)9173280299
Kakao : pilaedu
Line : pilaedu



48hrs before arrival

You have to register e-travel. Please refer departure orientation.

Having students insurance for your emergency situation.

Tuition fee (adult)

TUITION FEE								
COURSE TYPE	ESL (BUSINESS, SURVIVAL, TOEIC / 2times each only)				PRE		REGULAR	
	TRIAL	LITE	REGULAR	INTENSIVE	IELTS	TOEFL	IELTS	TOEFL
PRICE (4 weeks)	\$ 600	\$ 700	\$ 900	\$ 1,000	\$ 1,100	\$ 1,100	\$ 1,300	\$ 1,300

ACCOMMODATION FEE								
ROOM TYPE	DORMITORY W T/B			DORMITORY W/O T/B		CONDO WITH KITCHEN AND T/B		Enrollment fee
	SINGLE B	TWIN B	TWIN C	QUAD B	QUAD C	SINGLE A	TWIN A	
PRICE (4 weeks)	\$ 1,200	\$ 800	\$ 800	\$ 600	\$ 450	\$ 1,500	\$ 1,000	\$ 100

- At the end of the training, the deposit will be refunded after collectively deducting fees. (additional electricity costs), book prices, and laundry costs. (You will not receive a refund in the middle of the training.)
- Local and optional costs must be paid in full on the day of orientation. (If not paid, class cannot be conducted.)

Option fee / tuition fee calculation

Option fee

Title	Cost		Remark	
	before coming	At the spot		
meals	3 meals	\$360(4 weeks), \$120 (1 week)	\$450(4 weeks), \$150 (1 week)	<ul style="list-style-type: none"> Meals will be served Monday through Friday. (Weekend meal offer X) Lunch boxes or cafe food provided if special holidays are included on weekdays. Pre-application for meals can only be made on a four-week basis. Refund is not possible after requesting for a meal.
	2 meals	\$240(4 weeks), \$80 (1 week)	\$300(4 weeks), \$100 (1 week)	
	1 meal	\$120(4 weeks), \$40(1 week)	\$150(4 weeks), \$50(1 week)	
Additional classes		\$150		Additional man to man classes
		\$100		Additional small group classes
		\$80		replacement group class into man to man class
Weekend activities	Depends on activities		Island hopping, Canyoning, Watching Whale shark, City tour, Amusement park, Water park and Safari tour	

Tuition fee calculation

Calculation	REMARK
Tuition fee	Tuition fee + dormitory fee + enrollment fee = total fee
Local fee	Local fee must be paid on the orientation day.
period of enrollment	Some programs and dormitory type have minimum enrollment period (unless 4weeks)
under 4weeks enrollment	For those who register more than 4 weeks but less than 8 weeks, school fee shall be calculated by the product of "school fee for 4 weeks divided by 4" and "his/her registered weeks".
less than 8 weeks	1week fee = 40% of 4weeks fee, 2weeks fee = 70% of 4weeks fee, 3weeks fee = 90% of 4weeks fee.
Optional payment	Students are able to pay on the orientation day.

Local fee

TITLE	COST			REMARK		
	Adults					
Dormitory Deposit	₱3,000			Refundable after deducting expense of any room damages and delayed payments		
SSP	₱7,000			Valid for studying period		
SSP I-Card	₱4,000			Must apply with SSP		
I-Card (ACR)	₱3,500			Valid for a year (only for students who stay more than 8 weeks)		
ECC	₱1,500			For students who stay more than 6 months		
Miscellaneous	₱3,000 (4 weeks/per head)			For the maintenance of common facilities and utilities		
Electricity / Water	₱2,500 + ₱1,000 (4 weeks/per head)			Additional costs incurred when using electricity more than 2500 ₱ (1 watt 25 Pesos)		
Pick up / Drop off	₱1,200 (per head)			Drop off upon request		
Laundry	₱100 per 1kg			Using laundromat in the building (150 pesos for 2 hours)		
Books	₱400 ~ ₱700 (per book)			Depends on the students program		
School ID	₱500			Re-issuance fee - ₱500 (Lost ID)		
Room Key	None			Duplication of card keys - ₱500		
VISA Extension	4 weeks	8 weeks	12 weeks	16 weeks	20weeks	24weeks
	None	₱4,130	9,540	₱13,080	₱16,620	₱20,160

Refund policy / check-in & check-out

Refund policy

Description	Refund Amount	Remarks
4 weeks before departure	Full Refund	Refund all of school fee except registration fee.
2 weeks before departure	Partial Refund	Except 1week school fee and registration fee.
Within 2 weeks of schooling	Partial Refund	Except 4weeks school fee and registration fee.
After 2 weeks of schooling	50% (except difference)	Deduction of actual staying school fee and registration fee. 50% of least school fee from deduction
After 50% of schooling	No Refund	No refund after half of the class session is finished.
4 weeks before departure (condo)	Full Refund	Refund all of school fee except registration fee.
2 weeks before departure (condo)	Partial Refund	Except 4week condo fee, 1week tuition fee □ and registration fee.
Local fee	No Refund	Local fee paid are non-refundable.

- Enrollment fee is not refundable.
- Not be able to refund at all
 - Student doesn't inform their own illness(physically or mentally) and it gives cause disobey school regulation.
 - when they were expulsion, who doesn't follow school regulations.(Refer student management)
 - If there is a discount in the case of a refund, it will be converted into actual expenses and processed.

Check-in / check-out / deposit refund

Description	Refund Amount	Remarks
Check-in / check-out Deposit refund	Check-in / check-out	Check-in on Saturday 3PM/ Check-out on Saturday 12PM(regardless arrival time and date)
	Deposit refund	last week of Friday or the day before leaving
	Condo check-out	You have to pay for the room-service if you have when you return the key-card to condo



Thank You!



Website : www.Pilaeducation.com

Address : Tree wood, Sitio San Miguel Barangay Apas, Cebu City, Philippines

Contact : 0917-328-0299

Messenger : KaKao(Pilaedu), Line(pilaedu)